

## Crimpkontakte

Geeignet für Kabel AWG 16-20, 20-24 und 24-28

## Crimp contacts

Suitable for cable AWG 16-20, 20-24 and 24-28



Stift

Plug

**PX** Gedrehte Kontakte / Machined contacts

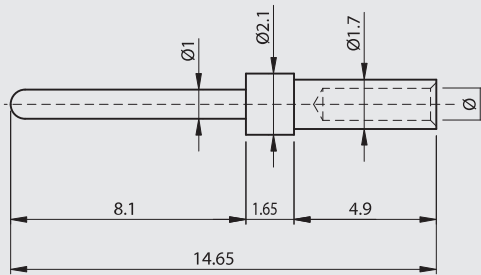

Buchse

Socket

**SX** Gedrehte Kontakte / Machined contacts

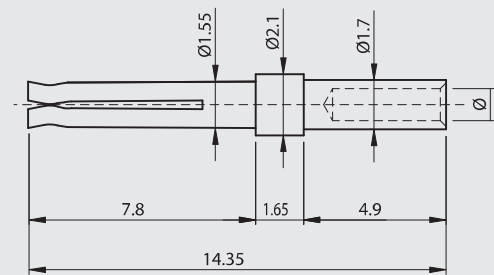

**P-XA** Gestanzte Kontakte / Stamped contacts

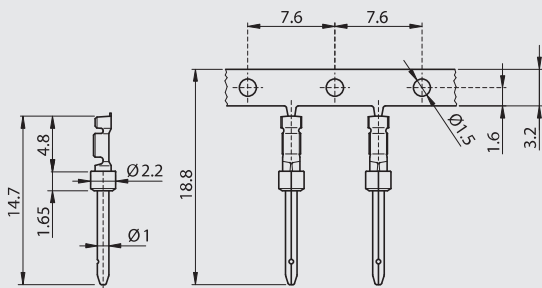

**S-XA** Gestanzte Kontakte / Stamped contacts

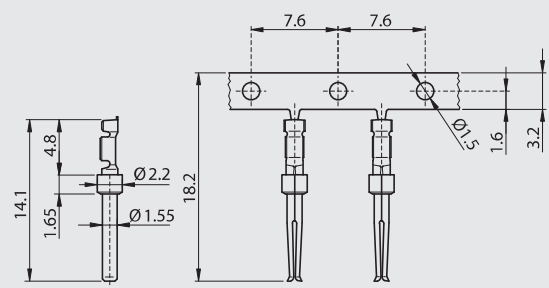

## Bestellbezeichnung

AWG	A in mm <sup>2</sup>	Ø in mm	
20-24	0.52-0.21	1.1	PX1 x
24-28	0.21-0.08	0.8	PX2 x
16-20	1.31-0.52	1.4	PX3 x
20-24	0.52-0.21		P-XA 1B x-y-z
24-28	0.21-0.08		P-XA 2B x-y-z

x = Anstelle des x der Artikelbezeichnung die gewünschte Güteklasse 1, 2 oder 3 einfügen.  
Andere Vergoldungen auf Anfrage.

y = **5K**: 5'000 Kontakte  
y = **10K**: 10'000 Kontakte

z = **L**: Abwicklungsrichtung links  
z = **R**: Abwicklungsrichtung rechts

## Order information

AWG	A in mm <sup>2</sup>	Ø in mm	
20-24	0.52-0.21	1.1	SX1 x
24-28	0.21-0.08	0.8	SX2 x
16-20	1.31-0.52	1.4	SX3 x
20-24	0.52-0.21		S-XA 1B x-y-z
24-28	0.21-0.08		S-XA 2B x-y-z

y = To request class 1, 2 or 3 quality, replace the x of the part no.  
Other gold platings on request.

y = **5K**: 5'000 contacts  
y = **10K**: 10'000 contacts

z = **L**: Direction of winding-up, left  
z = **R**: Direction of winding-up, right

Empfohlenes Hand-Crimpwerkzeug für PX und SX: RSW8723070261\_DigiCrimp 8.72  
Recommended hand crimp tool for PX and SX: RSW8723070261\_DigiCrimp 8.72